

# LSA-EU5-S

Linear Straight Actuator  
For Straight Single  
Locating Pins



European  
Standard Mounting  
TWICE the force

## Rigid, Precise , Powerful

The LSA-EU5 uses a ceramic bearing system that provides absolute rigidity. Side loads of 22kg are dynamically handled with less than 0.127mm of deflection at the locating pin. The force provided for pin removal is TWICE that of typical devices of this size with a 51mm equivalent bore.

## Easy to Apply

The LSA-EU5 is symmetrical and has an extremely narrow profile to fit anywhere and stay out of the way of weld guns and other tooling. The light weight of the unit allows it to be used in end-of-arm-tooling. World standard sensors are employed to simplify controls integration. A bronze anti-weld slag wiper in a non-conductive mount requires no insulation option. The LSA-EU5 uses 100% European standard mounting patterns and pins to assure easy design and assembly on the line. No orifices or other restrictions should be used in the application of Zaytran LSAs.

## Weld Immune

The LSA-EU5 uses the double bronze wiper that has protected tens of thousands of LSA units in automotive factories all over the globe. This system aggressively removes any weld slag from the heat treated shaft.

## Maintenance Free

The LSA-EU5 is guaranteed for the life of the tool (with design sign-off). There are no seals or plastic scrapers to change, no covers with pinch points, and, like all LSAs, the unit is lubricated for life!

**ZAYTRAN**  
AUTOMATION  
[www.auto-pin.com](http://www.auto-pin.com)

Distributed by: **FESTO**  
1-800-993-3786  
[www.festo.com](http://www.festo.com)

# ZAYTRAN LSA-EU5-S

Model Nomenclature:

LSA-EU5-S-X-YY-ZZ-R

X Ports: G (G-Class Port)

YY Stroke: 40 (40mm) or 60 (60mm)

ZZ Sensing: SEN (P+F Sensing), SEN-TRK (Turck Sensing)

R Reverse: Blank (Retract is home position) or R (Extend is home position)

Example: LSA-EU5-S-G-60-SEN

LSA-EU5-S with G Ports, 60mm of Stroke and P+F Sensing

Stroke: 40mm or 60mm  
 Equivalent Bore Dia: 51mm  
 Max Pressure: 8 bar (120 PSI)  
 Actuation: Pneumatic  
 Extend Force @ 4 bar (58 PSI): 84kg (185 lbs.)  
 Retract Force @ 4 bar (58 PSI): 63kg (140 lbs.)  
 Assembly Weight: 1.9kg (4.25 lbs)

The use of orifices or restrictors is not recommended.

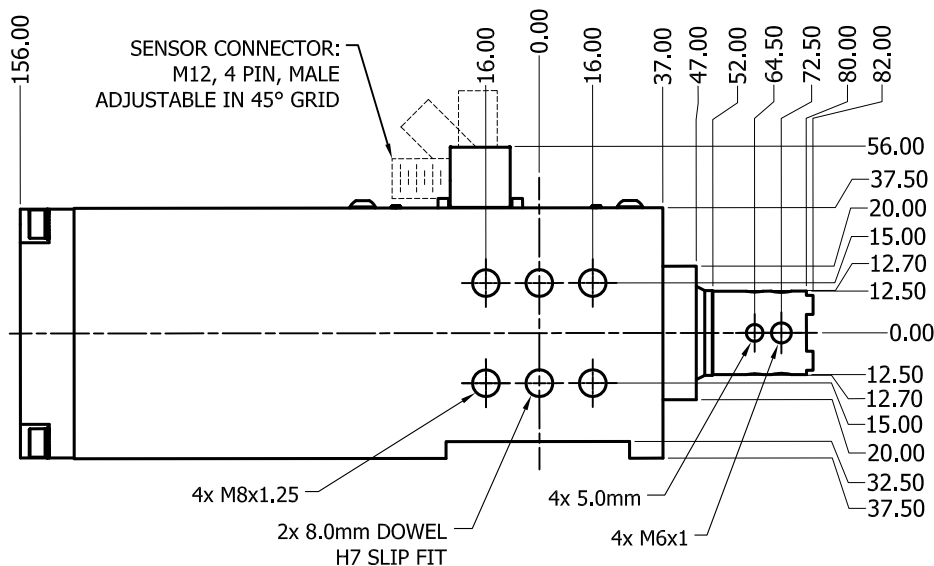

Sensor Information		
Pin	Color	Function
1	Brown	L+
2	White	Extend
3	Blue	L-
4	Black	Retract

Connector: M12, 4pin, male  
 Operating Voltage: 10V to 30V  
 Protection Degree: IP65  
 For use in direct and alternating field welding systems.

